

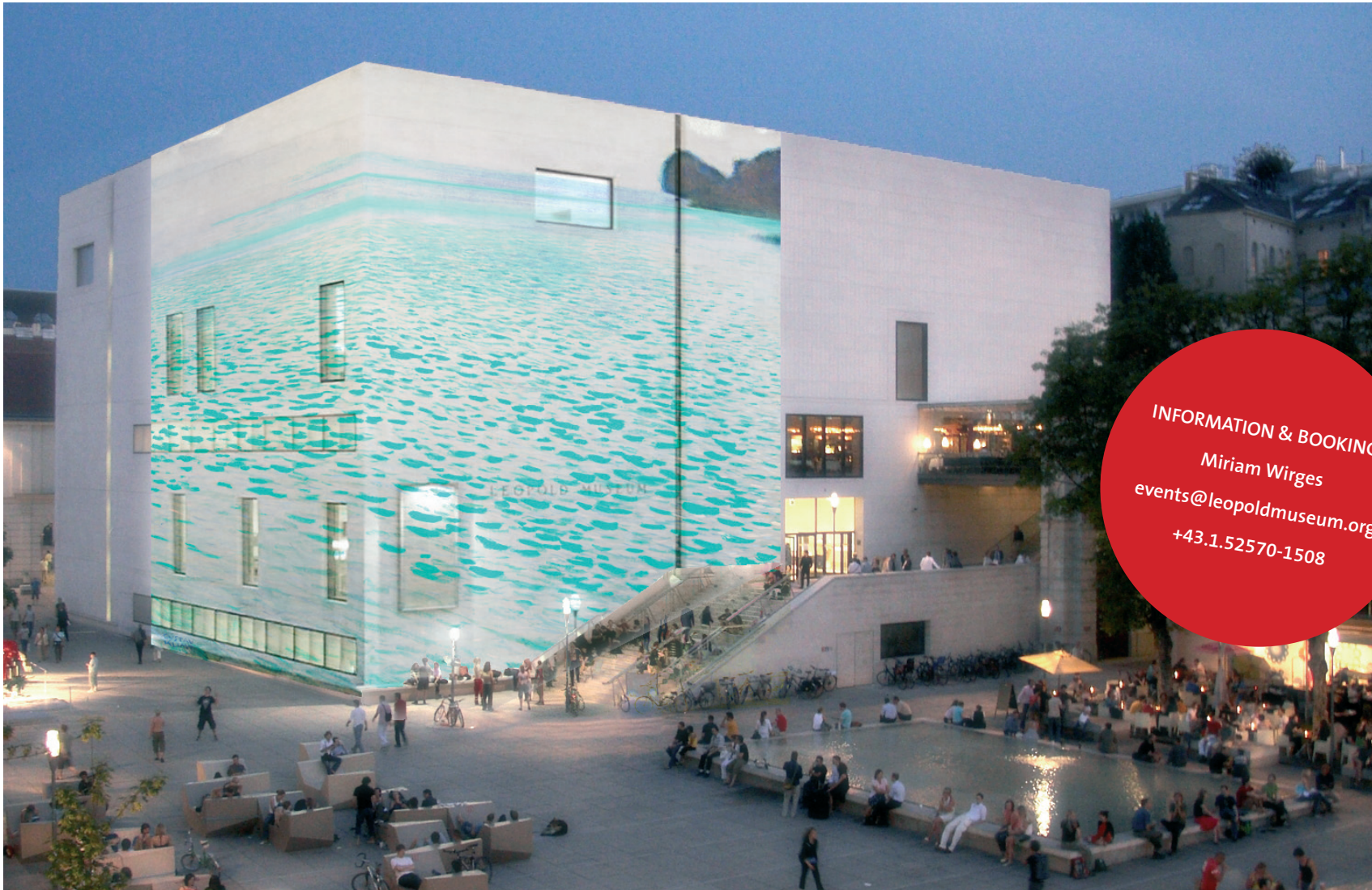

LEOPOLD
MUSEUM

CELEBRATING WITH SCHIELE & KLIMT

The Leopold Museum as Event-Location



INFORMATION & BOOKING:
Miriam Wirges
events@leopoldmuseum.org
+43.1.52570-1508



ATRIUM / 248 m² / Level 0



The museum's central space offers a unique ambience for presentations, receptions or gala dinners. Its cream shell limestone facing and airy expansiveness create an atmosphere of classic elegance.

FEATURES
chairs, tables, cocktail tables,
leather armchairs, ambient lighting

SEATING VARIATIONS
Gala dinner: up to 150 persons
Theatre: up to 240 persons
Cocktail: up to 250 persons

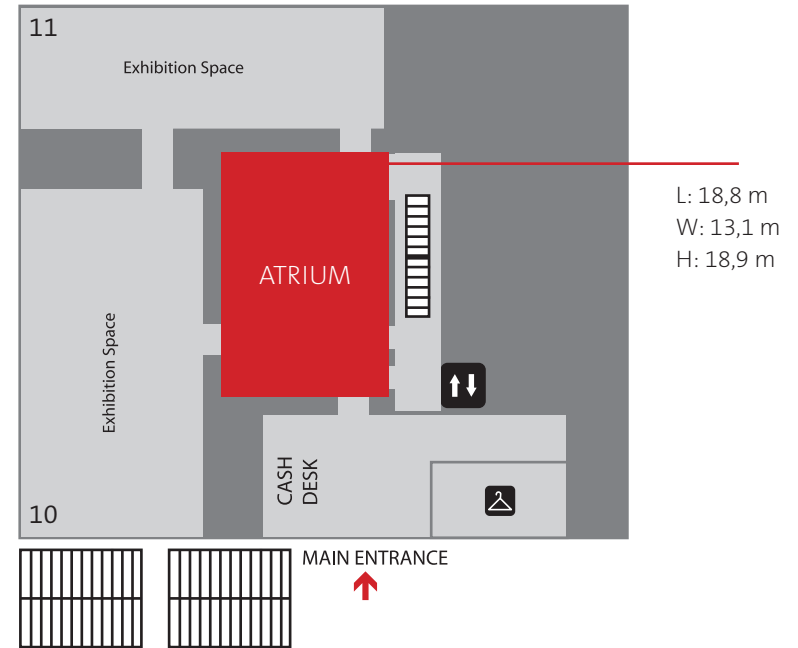

AUDITORIUM / 109 m² / Level -1



This lecture hall, with fixed theatre seating and the most modern technical equipment, is ideal for presentations, lectures etc. A separate entrance with its own foyer makes this space fully independent of museum operation.

FEATURES
projection screen, digitally controlled stereo tower with video projector, video recorder, DVD, CD, wireless microphone with automatic volume adjustment

FIXED SEATING
Theatre: 117 persons (up to 130)



L: 12,6 m
W: 8,5 m
H: 4,7 / 5,9 m

LOUNGE / 116 m² / Level 1



This area is ideally suited for small standing receptions and can also be used in combination with the Atrium. Its clever spatial arrangement, individual lighting concepts and modern furnishings including a bar create a unique atmosphere for your event. Upon request we would be happy to transform the Lounge into a stylish party location in co-operation with Cafe Leopold.

FEATURES
bar, leather armchairs, cocktail tables

SEATING VARIATIONS
Cafe: 50 persons
Cocktail: 70 persons

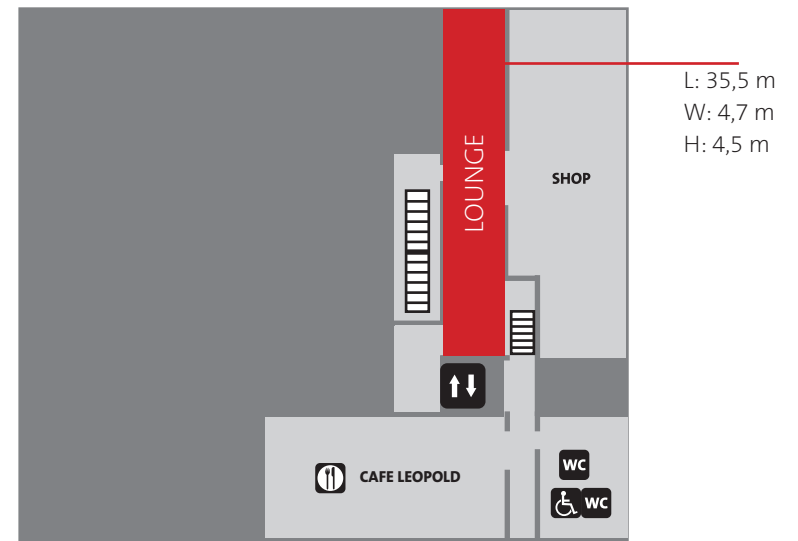

LOWER ATRIUM / 249 m² / Level -2



In addition to the Lower Atrium, level -2 offers up to three additional museum halls, making available an event space of up to 932 m². On account of its airy expansiveness and its creme shell limestone facing, the Lower Atrium provides an elegant setting for any event, be it a lecture, standing reception or conference. The availability of the extra halls on level -2 is dependent on exhibition planning and thus can only be ensured through a detailed inquiry.

FEATURES

chairs, tables, cocktail tables, dimmable ceiling lighting

SEATING VARIATIONS

Gala dinner: up to 150 persons

Theatre: up to 240 persons

Cocktail: up to 250 persons

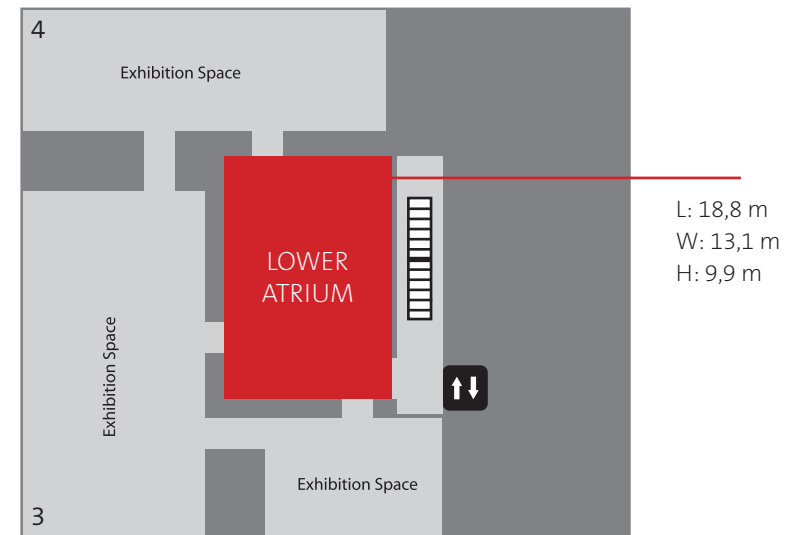

ATELIER / 74 m² / Level 1



The Atelier is a modern, light-filled space ideally suited for seminars, press conferences, presentations and workshops. Its long window wall creates a bright and transparent ambience that is inviting for a longer stay.

FEATURES

ceiling-mounted video projector,
projection screen, chairs, tables, blinds,
separate restrooms

SEATING VARIATIONS

U table: up to 15 persons

Cafe: up to 30 persons

Cinema: 40 to 50 persons

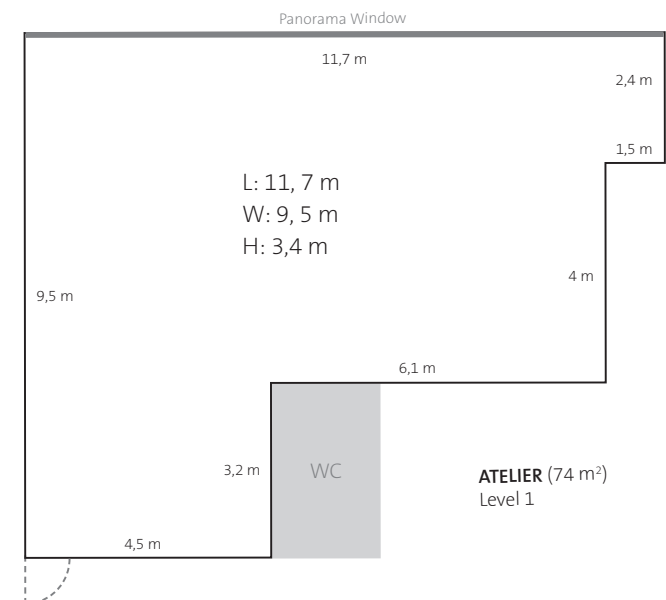

EXCLUSIVE EVENING PROGRAMME AT THE LEOPOLD MUSEUM

Experience the difference. Outside of its regular opening hours, the museum's unique ambience is even more impressive, making for an unforgettable evening.



GUIDED TOURS & SERVICE

Spend a wonderful evening at the museum with an exiting tour of the permanent collection or of the current special exhibition. The evening is rounded out by a cocktail reception with sparkling wine or Champagne and a variety of seasonal delicacies.

Please select from among the following variations:

LEOPOLD DELUXE

3 beverages: Champagne, fresh-squeezed fruit juice, mineral water
Additionally the guests will be served a special selection of seasonal cold and warm finger food.

LEOPOLD SPECIAL

4 beverages: Prosecco, white wine, fruit juice, mineral water
Additionally the guests will be served seasonal cold and warm finger food.

LEOPOLD CLASSIC

3 beverages: Prosecco (classic, with fig-mint syrup or sage-lemon), fruit juice, mineral water
Additionally the guests will be served seasonal cold finger food.

LEOPOLD TOUR

We would also be happy to arrange exhibition tours without catering service.

Programme Persons	0 - 20	21 - 50	51 - 80	81 - 110
LEOPOLD DELUXE	2.070,-	3.790,-	5.040,-	6.350,-
LEOPOLD SPECIAL	1.870,-	3.190,-	4.510,-	5.850,-
LEOPOLD CLASSIC	1.670,-	2.690,-	3.710,-	4.750,-
LEOPOLD SPARKLING*	1150	1990	2710	3370
LEOPOLD TOUR	910,-	1.390,-	1.750,-	2.050,-

sämtliche Preise in Euro, exkl. 20% MwSt

Booking conditions

- *) Service: MOTTO Catering – high-quality seasonal food and drink
- *) 1h tour and max. 1h catering service
- *) Start at 6:00 p.m. or 6:30 p.m., beginning with tour or service
- *) Guided Tours can be booked in the following languages: German, English, French, Italian, Spanish, Serbian, Hungarian
- *) LEOPOLD TOUR: Start between 6:00 p.m. and 7:00 p.m., duration 1h

INFORMATION & BOOKING:
Miriam Wirges
events@leopoldmuseum.org
+43.1.52570-1508